

#### Application:

Isolating valve for the isolation or throttling of fluids or air.

#### Description:

Needle type straight pattern valve for the isolation or throttling of fluids or air.

The brass valve has a metal seat. Sealing to the outside is guaranteed by a gland packing which can be re-tightened.

#### Technical data:

Item no.: 2091002

Connection: Female thread Rp 1/4 according to DIN EN 10266-1

Fluids: Fluids, e.g. mineral, heating or hydraulic oils or air

Material: Brass

Nominal pressure: PN 16, for air PN 6

Temperature range: 0 °C up to 60 °C

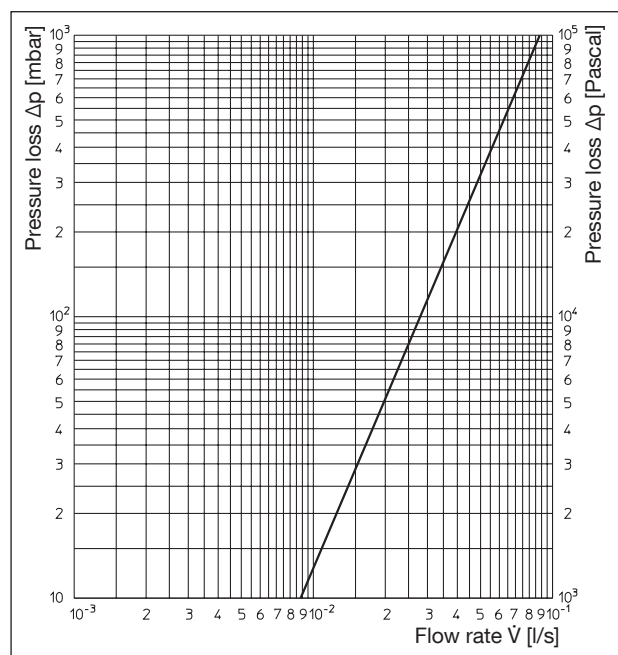

Flow chart

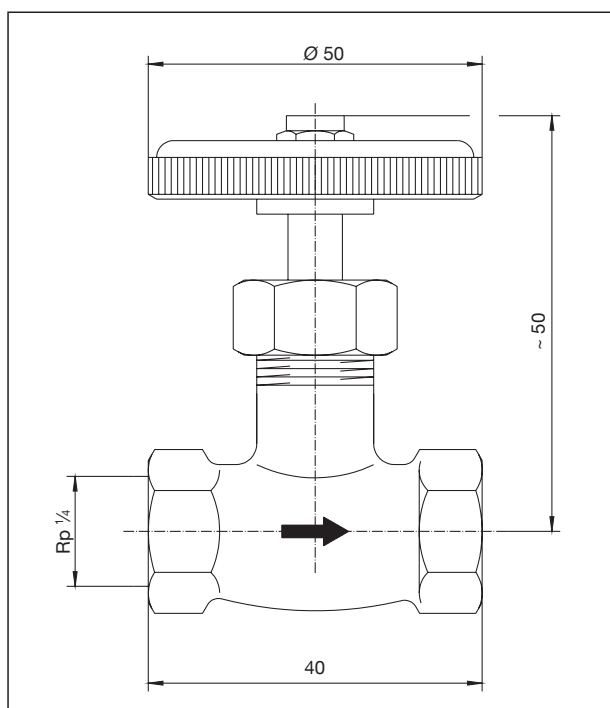

Dimensions

Subject to technical modifications without notice.

Product range 9  
ti 346-EN/10/MW  
Edition 2016