

Fill and drain cock, bronze, PN 16
Heavy pattern model according to DIN 3848.

Application:

The Oventrop fill and drain cock with hose connection is used for heating systems and pipework which have to be equipped with a filling and draining facility.

Male threaded connection with hose connection and cap.

The fill and drain cock with hose connection is suitable for treated heating water with a glycol proportion up to 50 %.

Technical data:

Construction:	Fill and drain cock, heavy pattern according to DIN 3848.
Connections:	Installation with R male thread, outlet port with hose connection
Application:	Water, heating water with a glycol proportion up to 50 %, non-aggressive fluids
Operating pressure p_s :	16 bar (PN 16)
Operating temperature t_s :	0 °C up to 150 °C, for short periods up to 180 °C
Material:	
Body, plug:	Bronze
Gland for shaft sealing:	PTFE graphite compound
Hose connection:	Brass

Flow values (including hose connection):

DN	10	15	20	25
k_{vs}	1.8	3.5	8.5	14.5

Operation and maintenance:

The fill and drain cock is opened/closed by turning the square by 90°. The position of the plug is indicated by a marking on the upper side of the square.

To guarantee tightness during operation, a readjustment of the fill and drain cock might become necessary in case of:

- Operation at low temperatures
 - Extreme temperature changes
 - Use of penetrating additives in heat transfer liquids
- Readjustment is carried out by turning the collar nut below the square clockwise with the help of a suitable spanner.

Keys for fill and drain cock:

Spanner size 12 for DN 10 and DN 15
Spanner size 14 for DN 20 and DN 25

Item no.:

1035004
1035006



Fill and drain cock with hose connection

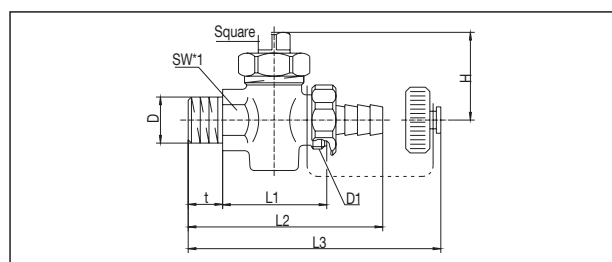

Dimensions item no.: 1032003-08 (DN 10 up to DN 25)

DN	D	D ₁	L ₁	L ₂	L ₃	t	H	SW*	Square
10	R 3/8	G 1/2	40.5	79	60	12	39	22	12
15	R 1/2	G 3/4	47.5	89	68	15	41	24	12
20	R 3/4	G 1	53.5	102	78	17	46	27	14
25	R 1	G 1 1/4	62.5	128	94	20	60	36	14

SW = Spanner size

Subject to technical modifications without notice.

Product range 6
ti 295-EN/10/MW
Edition 2017

