

Tender specification:

Oventrop flushing station "Regudrain" for the protection of PWC and/or PWH risers and maintenance of normal operation in potable water systems, for instance during interruptions of use. For the installation at the end of the riser or in ring circuits. Completely pre-assembled and leak tested unit. Bracket for front-wall installation systems. Insulation made of expanded polypropylene. Flushing riser with solenoid valve and flow sensor, with isolating facility. Free outlet type AB according to EN 1717 for the connection to the sewerage network.

Electronic controller "Regtronic HS" for valve control, individually programmable, with web access via LAN or WLAN and log function.

Technical data:

Application: Potable water installations

Max. operating temperature:	70°C, for short periods up to 80 °C
-----------------------------	-------------------------------------

Min operating pressure: 1 bar

Max. operating pressure: 10 bar (PN 10)

Flushing capacity per riser: Flow controller 5 (l/min) or 7 (l/min)

Max. flushing capacity
free outlet: 10 (l/min)

Materials: Brass, EPDM, PTFE , insulation made of expanded polypropylene

Connections
potable water circuit : G 3/4 male thread, flat sealing,
according to ISO 228

Connections
sewerage network: DN 40

Solenoid valve: closed with current "off",
24 V DC

Flow sensor: 1-30 l/min

Electronic controller "Regtronic HS"

Operating current: 24 V DC

Power pack: 230V AC / 24V DC

Alarm output: 24 V DC for volt free

Inputs: 2x temperature sensor PT1000
1x humidity sensor

Web access via LAN or WLAN, individually programmable, with log function

Models:

“Uno” (1 flushing riser)

“Duo” (2 flushing risers)

Item no.:

4207004

4207005

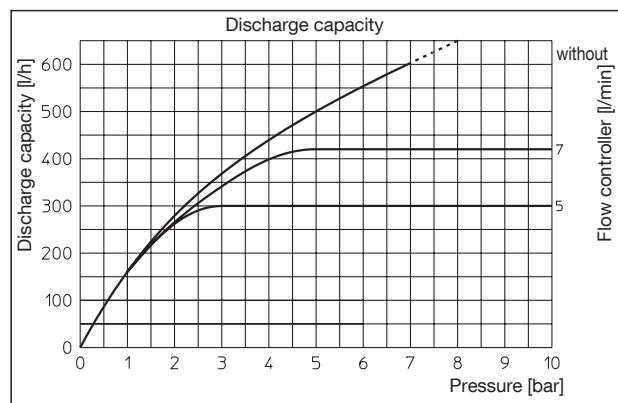

Flow characteristic line

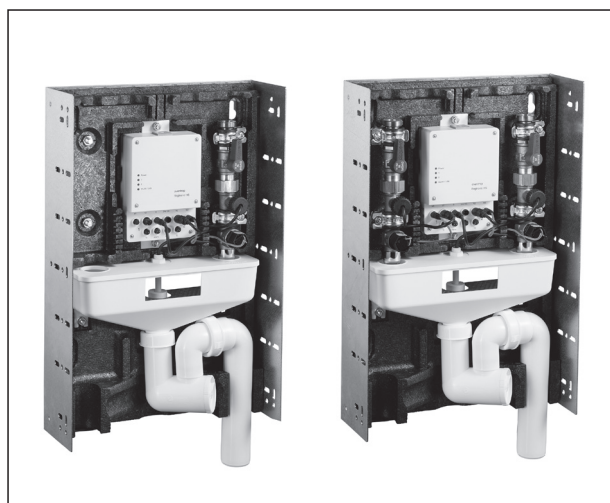

Flushing station "Regudrain", models "Uno" and "Duo"

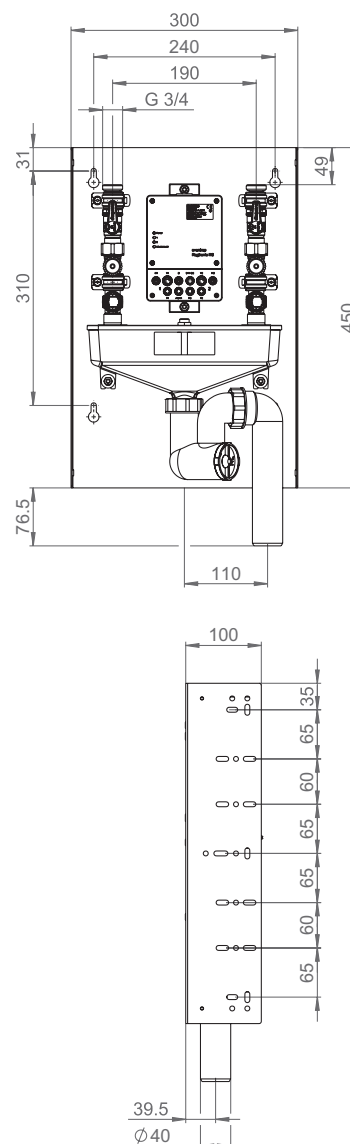

Dimensions

Accessories:

Extension set “Duo”
 for the extension of the model “Uno”
 by a second flushing riser
 including fixing material
 Item no. 4207094

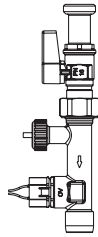

Tiling ready frame
 Item no. 4207090

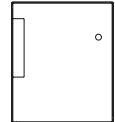

Surface-mounted cover for flushing station
 steel, galvanised, white lacquered
 Item no. 4207091



Extension set ring circuit
 “h” fitting for the connection in ring circuits
 G 3/4 collar nut x G 3/4 x G 3/4
 Item no. 4207095

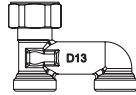

Flushing valve 24 V DC
 with flow sensor,
 flow controller and jet regulator
 Item no. 4207092

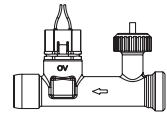

“Sensor LW TQ”
 Sensor element PT 1000
 G 1/4, bronze body,
 temperature sensor made of stainless steel
 2 wire system
 Item no. 1150090



Siphon for flushing station
 Item no. 4207093

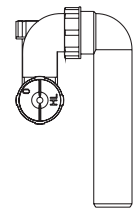

Temperature sensor attached to the pipe
 Sensor element PT 1000,
 with fixing clamp and heat conducting paste
 Item no. 1369095

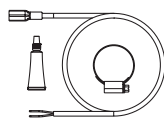

Humidity sensor
 Item no. 4207099

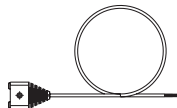

Jet regulator for flushing valve
 Item no. 4207097



Sensor cable
 1500 mm, bipolar with plug
 and connecting terminal
 Item no. 4207098

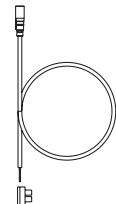

Flow controller for flushing valve
 Item no. 4207096 (model 5 l/min)
 Item no. 4207089 (model 7 l/min)

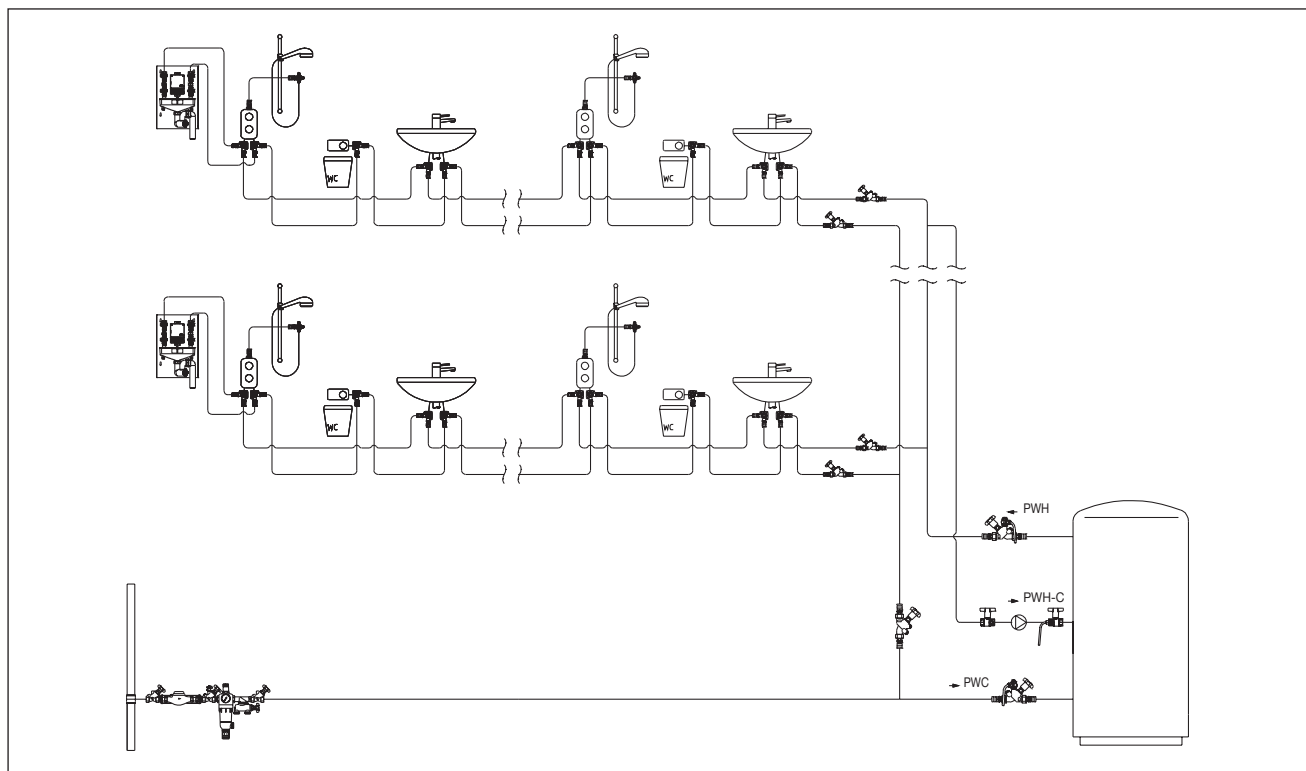

System illustration: Flushing station “Regudrain” for the maintenance of normal operation

Subject to technical modifications without notice.

Product range 8
 ti 335-EN/10/MW
 Edition 2017