

Application:

The Oventrop ball valve with hose connection is used for heating systems and pipework which have to be equipped with a filling and draining facility.

Female thread, lever with stop, with hose connection (soft seal) and cap, stem with double O-ring seal.

The ball valve with hose connection is suitable for treated heating water with a glycol proportion up to 50 %.

It distinguishes itself by its high filling and draining capacity.

Function:

The ball valve is opened/closed by turning the lever by 90°. The position of the ball is indicated by the position of the lever which moves parallel to it.

Ball valve with hose connection:

PN 16, brass, nickel plated, Rp female thread according to EN 10226-1, full flow, lever with stop.

Application: Water, heating water with a glycol proportion up to 50 %, saturated steam, compressed air, heating oil and fuels

Operating pressure p_s : 16 bar (PN 16),
10 bar for air and other harmless gaseous fluids (not for gaseous fluids group 1 according to directive 2014/68/EU)

Operating temperature t_s : -20 °C* up to +120 °C
* prevent formation of ice

Materials:

Body: CuZn40Pb2, nickel plated
Switching ball: CuZn40Pb2, chrome plated
Stem: CuZn40Pb2
Stem seal: 2 x FKM O-ring
Ball seats: PTFE
Hose connection: Brass, nickel plated
Lever: Steel, galvanized with red plastic coating

Flow values (including hose connection):

DN	15	20	25
K_{vs}	5.3	10.4	19.0



Ball valve with hose connection

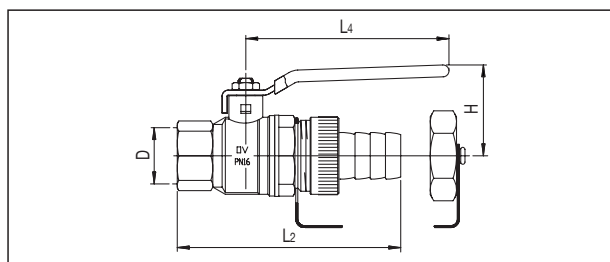

Dimensions item no. 1036154-58 (DN 15 up to DN 25)

DN	D	L ₂	L ₄	H	SW*
15	Rp 1/2	~ 85.0	100	~ 43	25
20	Rp 3/4	~ 100.5	120	~ 50	31
25	Rp 1	~ 130.5	120	~ 54	40

SW = Spanner size

Subject to technical modifications without notice.

Product range 6
ti 297-EN/10/MW
Edition 2017

