

## Cocon AQH

### Pressure independent control valve

DN 15



Compact, pressure independent control valve for flow control of small consumers in conjunction with an actuator.

#### Functions

- Pressure independent flow control
- Adjustable between 35 and 420 l/h
- Shutoff

#### Features

- + Flow control from 35 l/h
- + Very compact, can also be used in tight installation situations
- + Removal of the valve insert under pressure using the Demo-Bloc

#### Technical Data

Nominal size	DN 15	
Variant	With external thread according to ISO 228	
Operating temperature	2...110 °C	
Max. operating pressure	max. 10 bar / PN 10	
Max. differential pressure $\Delta P$	150 kPa (1.5 bar)	
Min. differential pressure $\Delta P$	35...170 l/h: 15 kPa >170...300 l/h: 20 kPa >300...420 l/h: 25 kPa	
Medium	Heating or cooling water according to VDI 2035 or ÖNORM 5195 Water-glycol mixtures with a max. glycol content of 50%	
Actuator connection	Connection thread:	M30 x 1.5
	Valve stroke:	1.1 mm
	Closing dimension:	11.8 mm
	Actuator closing force:	90...150 N

Normal valve function is also ensured below the differential pressure  $\Delta P$  min.; the flow rate is merely reduced compared to the setpoint.

# Functions

## Flow control

The Cocon AQH keeps the flow within the differential pressure control range ( $\Delta P$ ), coloured green in the chart, constant. Within the  $\Delta P$  control range, the flow is not influenced by the differential pressure and is therefore pressure independent.

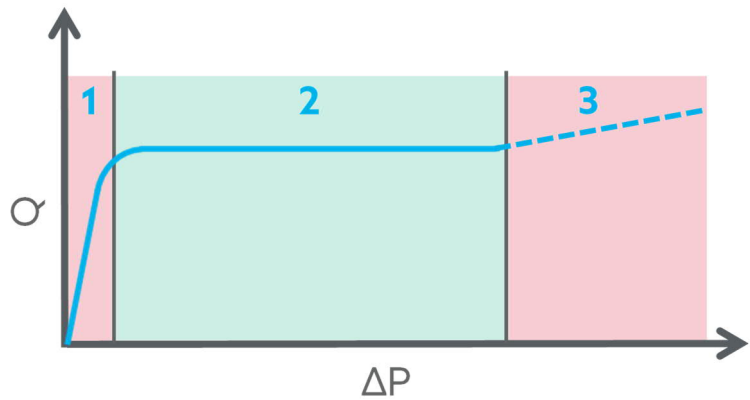

1	2	3
Below the $\Delta P$ control range	Within the $\Delta P$ control range	Above the $\Delta P$ control range
The flow rate $Q$ increases depending on the differential pressure on the Kv characteristic line.	The flow rate $Q$ is controlled independently of the differential pressure to the setpoint value.	The flow rate $Q$ continues to increase depending on the differential pressure. There is a risk of noise and/or oscillations.

### FLOW RANGE

The adjustable flow range is 35 to 420 l/h. The setpoint is adjusted directly on the valve insert using the supplied presetting key. The valve insert has a scale with readings in l/h, i.e. the required setpoint can be set directly without conversion.

### $\Delta P$ CONTROL RANGE

The maximum control-related differential pressure is 150 kPa. For low-noise operation in conjunction with a noise sensitive system, the maximum differential pressure across the valve should not exceed 60 kPa.

The minimum differential pressure depends on the setpoint value:

Setpoint value $Q$	Minimum differential pressure $\Delta P$
from 35 to 170 l/h	15 kPa
over 170 to 300 l/h	20 kPa
over 300 to 420 l/h	25 kPa

## Shutoff

The pipe can be temporarily shut off using the protection cap supplied. The sole, permanent and unattended shutoff of the valve against atmosphere is not permissible. In this case, also provide a shutoff cap/plug on the pipe connection.

# Item Details

## Item Number

**1142064** Cocon AQH pressure independent control valve, DN15, G 3/4 external thread, flat sealing, control range 35 to 420 l/h

## Dimensions

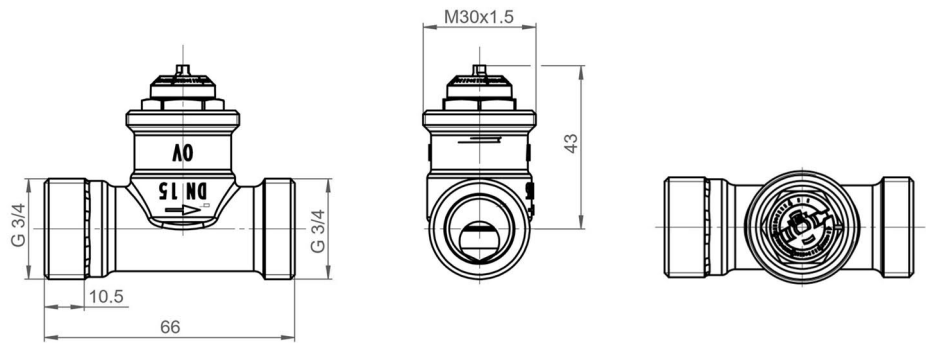

Dimensions in mm unless otherwise specified

# Accessories

## Fittings



Connection thread with externally threaded tailpipes.  
Consisting of two tailpipes R 1/2, two union nuts Rp 3/4 and two sealing rings.

Item no.

1140792

## Screen insert



The screen insert is snapped onto the plug of the Cocon AQH valve insert and can be used under pressure with the Demo-Bloc **1188051**.

Item no.

1187090

## Demo-Bloc



Special tool for replacing the valve inserts under pressure. Connection thread M30 x 1.5. Including coupling set for AQH valve inserts.

Item no.

1188051

## Aktor T thermal actuators



Aktor T (on/off)  
Normally closed

Version

Cable length

Item no.

230 V AC

1 m

1012415

2 m

1012452

5 m

1012455

10 m

1012459

24 V AC/DC

1 m

1012416

2 m

1012442

120 V AC

1 m

1012420

Aktor T (on/off)  
Normally open

230 V AC

1 m

1012425

24 V AC/DC

1 m

1012426

## Aktor M motorised actuators



Aktor M (on/off)  
Short running time

Version

Cable length

Item no.

230 V AC

1.5 m

1012710

24 V AC/DC

1.5 m

1012711

## Spare parts



1651182

Designation

Item no.

Presetting key

1651182

Protection cap (anthracite)

1146091

AQH valve insert

1187095



1146091

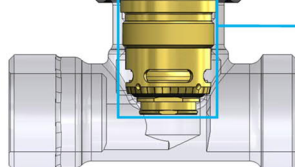

1187095