



Station “Regumaq XZ-30” for hot potable water preparation

### Safety in potable water installations

The Oventrop “Regumaq X-30” and “Regumaq XZ-30” fresh water stations are electronically controlled product assemblies with heat exchanger for the hygienic heating of potable water according to the flow principle. The potable water is only heated when it is needed, i.e. “just in time”. A potable water reserve is thus not necessary.

### Application:

With this product range, an optimum realization of regenerative pipework concepts is possible: The stations are connected to a buffer storage cylinder which can be heated up by different heat sources (solid fuels, oil, gas or solar energy). Transmission of the heat is controlled electronically so that only the water drawn off during the draw off operation is heated via the plate heat exchanger.

**For this reason, the stations fulfil a high hygienic demand:  
A potable water reserve is not necessary and the risk of a legionella contamination is reduced.**

To increase the comfort of hot potable water supply in a circulation installation, the station “Regumaq XZ-30” is equipped with an integrated circulation pump. The controller can be adapted to the individual requirements of the installations user.

The stations “Regumaq X-30” and “Regumaq XZ-30” can be used in new buildings and for the renovation of existing detached houses and multiple dwellings.

### Models:

- **“Regumaq X-30”**  
Station for hot potable water preparation with electronic controller  
Model with copper brazed heat exchanger **Item no. 1381030**  
Model with heat exchanger completely made of stainless steel **Item no. 1381032**
- **“Regumaq XZ-30”**  
Station for hot potable water preparation with electronic controller and additional circulation pump  
Model with copper brazed heat exchanger **Item no. 1381035**  
Model with heat exchanger completely made of stainless steel **Item no. 1381037**

### Advantages:

- product assembly with heat exchanger ready for connection
- realization of individual pipework configurations
- heating of potable water according to the continuous flow principle, the water is only heated when it is needed
- fulfilment of high hygienic demands
- no potable water reserve required
- reduced risk of legionella contamination
- power consumption and stand-by loss are reduced due to an intelligent circulation pump control

For further information please contact:

OVENTROP GmbH & Co.KG  
Paul-Oventrop-Straße 1  
D-59939 Olsberg  
Phone +49 2962 82 0  
Fax +49 2962 82 450  
E-Mail mail@oventrop.de  
Internet www.oventrop.com

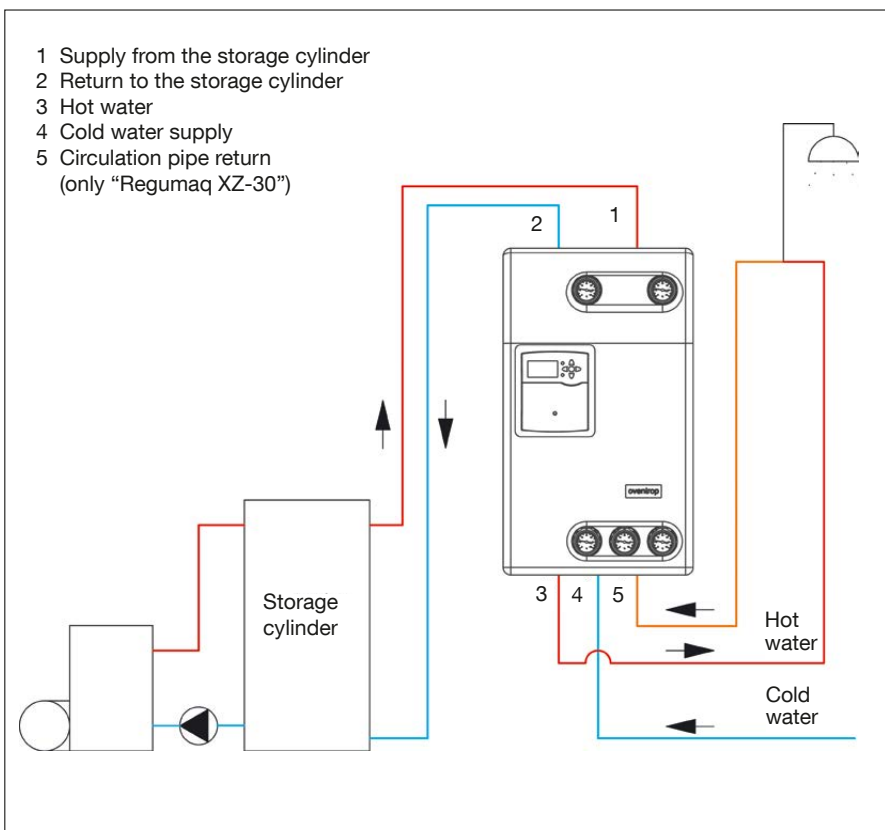

System illustration:  
Integration of a station for hot potable water preparation “Regumaq XZ-30” into a potable water circulation